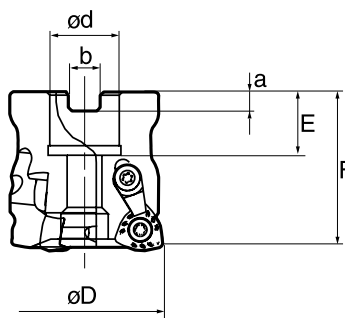

TXP**JETMILL HIGH FEED**Specifications
Super High Feed Face Mill

Corner Angle		-
Rake Angle	Axial	+5°
	Radial	-4° ~ -6°

Catalog Number	Stock	# of Teeth	Dimensions (in)						Wt. lbs.
			D	d	E	F	a	b	
TXP08050RU	●	3	2.000	0.750	0.750	1.969	.197	.315	.87
TXP08080R	●	5	3.150	1.250	1.260	2.480	.315	.500	3.2
TXP08300RU	●	5	3.000	1.000	1.024	2.480	.236	.375	3.2
TXP08100R	●	6	3.937	1.250	1.260	2.480	.315	.500	5.8
TXP08400RU	●	6	4.000	1.500	1.260	2.480	.394	.625	5.8
TXP08125R	○	7	4.921	1.50	1.77	2.480	0.393	0.625	6.8
TXP08160R	○	8	6.299	2.00	1.77	2.480	0.433	0.750	11.2
New TXP09063R	○	3	2.480	22mm	0.78	1.968	0.236	10mm	1.3
New TXP09080R	○	4	3.150	1.25	1.26	2.480	0.315	0.500	2.8
New TXP09100R	○	5	3.937	1.25	1.26	2.480	0.315	0.500	5.3
New TXP09125R	○	6	4.921	1.50	1.50	2.480	0.393	0.625	6.8
New TXP09160R	○	7	6.299	2.00	1.50	2.480	0.433	0.750	10.4

Milling Tools

Inserts

Catalog Number	Class	Grade		
		AH120	AH140	T3030
WPMT080615ZSR	M	●	●	●
WPMT080615ZPR-ML	M	●	●	●
WPMT080615ZSR-MH	M	●	●	○
WPMT090725ZSR	M	●	○	○
WPMT090725ZPR-ML	M	○	○	○
WPMT090725ZSR-MH	M	●	●	○

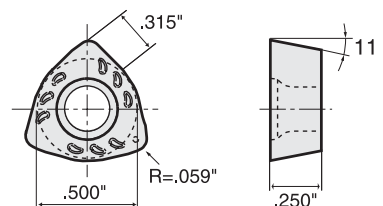
**Parts**

Catalog Number	Insert Screw	Insert Clamp	Wrench
TXP08	CSTB5	CSX20	T20T
TXP09	CSPB5	CSY20	IP20T

Recommended Cutting Conditions

Work Material	Grade	V (sfm)	F (ipt)	Depth of Cut (inch)
Low Carbon	AH120 T3030	500~825	.020 ~ .080	~0.060
Alloy Steels	AH120 T3030	350~650	.020 ~ .080	~0.060
Die Steels 30 ~ 40 Rc	AH120	260~500	.020 ~ .040	~0.060
Cast Irons Ductile Iron	AH120	500~825	.030 ~ .100	~0.060

Note: The TXP cutter can be used with or without coolant, however for best performance we recommend dry cutting with an air blast.

●: Stocked Standard
Chicago Warehouse
○: Stocked Standard

Japan Warehouse Shipment Within 1-2 Weeks